

Flo-Torq I Propeller Installation

1. Install the thrust washer onto the propeller shaft.
2. Install the propeller.
3. Install the tab washer, and secure with the nut. Tighten the nut to the specified torque. Bend the tabs on the tab washer onto the nut.

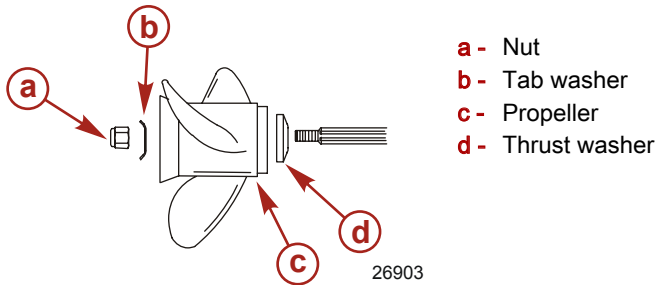

- a - Nut
- b - Tab washer
- c - Propeller
- d - Thrust washer

Description	Nm	lb-in.	lb-ft
6–15 hp propeller nut	11.3	100	
18–25 hp propeller nut	22.6		16.7
30–60 hp propeller nut	74.6		55

4. Rotate the propeller to verify interference or binding does not exist between the gear housing and the propeller.

Flo-Torq II Propeller Installation

1. Install and align all of the components.
2. Tighten the nut to the specified torque.
3. Bend the tabs of the tab washer into the rear thrust hub.
4. The propeller must be locked between the forward thrust washer and aft adapter. The propeller must not move on the propeller shaft.

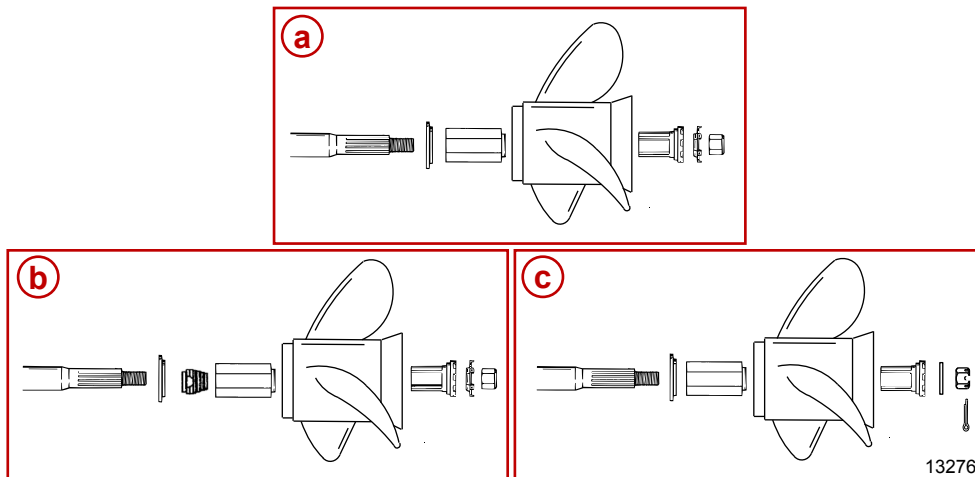

- a - Mercury, Mariner, Mercury MerCruiser, Force, Honda®
- b - Revolution 4, Tempest Plus, Trophy Plus, and Bravo I
- c - Mariner, Evinrude®, Johnson®, OMC®, Suzuki®, Yamaha®, Tohatsu®, Nissan®, Volvo®, Honda®

Description	Nm	lb-in.	lb-ft
Propeller nut	74.6		55

5. Rotate the propeller to verify interference or binding does not exist between the gear housing and the propeller.

Flo-Torq III and Flo-Torq IV Propeller Installation

1. Install and align all of the components.
2. Tighten the nut to the specified torque.
3. Bend the tabs of the tab washer into the rear thrust hub.
4. The drive sleeve must be locked between the forward thrust washer and aft adapter.

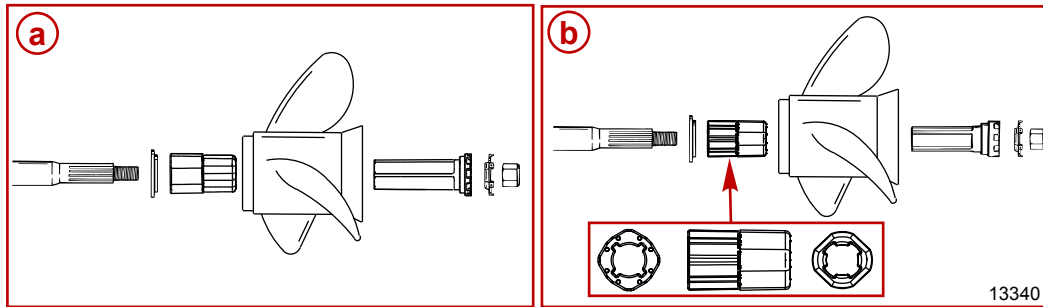

- a** - Flo-Torq III propellers
- b** - Flo-Torq IV propellers

Description	Nm	lb-in.	lb-ft
Propeller nut	74.6		55

5. Rotate the propeller to verify interference or binding does not exist between the gear housing and the propeller.
NOTE: A small amount of rotation play and forward aft play is normal.